



**SB**  
**SERIES**

## Washer-Extractor

**60, 80, 155, 225, 300, 485**  
pound capacities



# SB Series

The SB Series – Softmount Barrier Washer-Extractors for Small, Medium, and Large Sized On Premise Laundry Applications Where Hygiene is a Major Concern, Including Health Care and Clean Room Operations.

## Outstanding Reliability and Efficiency at an Affordable Price

The SB Series is Designed to be Effortless and Powerful While Maintaining Low Cost of Ownership:

- ◆ Investment cost returned through increased efficiency
- ◆ Fewer parts means less downtime
- ◆ Up to 350G extraction equals less time in the dryer, yielding tremendous savings
- ◆ Extremely easy installation, no special foundation requirements
- ◆ Can be installed on upper floors and other difficult locations
- ◆ Low maintenance, long lasting, labor saving



### The EL6 Advanced Microprocessor Control

- ◆ Easy to use
- ◆ 30 wash programs
- ◆ Trouble-free
- ◆ 8 chemical signals
- ◆ Programmable water levels, speeds and more
- ◆ Incredibly flexible - handles demanding operations

### Large Door Opening and Safe Door Interlock

- ◆ Stainless steel construction
- ◆ Silicon door gasket
- ◆ Locking system engineered for reliability and ease of use
- ◆ Only one door may be opened at a time, preventing cross contamination.





## Design Features

- ◆ Designed to be built into the wall separating the clean and soiled sides of the laundry
- ◆ SB-60 and SB-80 are open pocket
- ◆ SB-155, SB-225, and SB-300 are 3 pocket
- ◆ SB-485 is 6 pocket (3+3).
- ◆ Heavy duty bearings and housings for longevity

---

## Robust Energy Efficient Inverter Drive System

- ◆ Incredibly flexible operation
- ◆ Excellent protection for the motor
- ◆ Latest technology for precise speed control
- ◆ Single motor drive without clutches and complication
- ◆ Up to 350G high speed extract



## Freestanding Construction

- ◆ Withstands the rigorous demands of continuous operation
- ◆ Tuned suspension system with heavy duty springs and industrial shock absorbers (SB-60, SB-80)
- ◆ Air cushion suspension system standard on SB-155 through the SB-485
- ◆ Easy installation with no special foundation requirements

---

## Supply Dispenser

- ◆ 5 compartments accept liquid or powder
- ◆ Programmable automatic flushing
- ◆ Side mounted
- ◆ Convenient height for easy access
- ◆ 8 chemical signals standard



**The SB Series from B&C Technologies: Reliable, Durable, Affordable**

# Specifications

| Model                                | Units  |          | SB-60 |      | SB-80 |      | SB-155  |      | SB-225  |      | SB-300  |      | SB-485  |       |
|--------------------------------------|--------|----------|-------|------|-------|------|---------|------|---------|------|---------|------|---------|-------|
|                                      | Metric | US       |       |      |       |      |         |      |         |      |         |      |         |       |
| Max. Loading 1:10                    | Kg     | Lbs      | 27    | 60   | 36    | 80   | 70      | 155  | 102     | 225  | 136     | 300  | 220     | 485   |
| <b>Overall Dimension</b>             |        |          |       |      |       |      |         |      |         |      |         |      |         |       |
| A - Width                            | mm     | Inch     | 1302  | 51.3 | 1492  | 58.7 | 1615    | 63.6 | 1973    | 77.7 | 2325    | 91.5 | 2617    | 103.0 |
| B - Depth                            | mm     | Inch     | 1279  | 31.1 | 1279  | 50.4 | 1596    | 62.8 | 1596    | 62.8 | 1765    | 69.5 | 2154    | 87.8  |
| C - Height                           | mm     | Inch     | 1681  | 66.2 | 1681  | 66.2 | 2124    | 83.6 | 2124    | 83.6 | 2120    | 83.5 | 2441    | 96.1  |
| <b>Wash Cylinder Information</b>     |        |          |       |      |       |      |         |      |         |      |         |      |         |       |
| Diameter                             | mm     | Inch     | 790   | 31.1 | 790   | 31.1 | 1069    | 42.1 | 1069    | 42.1 | 1200    | 47.2 | 1400    | 55.1  |
| Depth                                | mm     | Inch     | 560   | 22.0 | 750   | 29.5 | 790     | 31.1 | 1150    | 45.3 | 1205    | 47.4 | 1430    | 56.3  |
| Volume                               | liters | ft3      | 270   | 9.5  | 370   | 13.3 | 710     | 25.0 | 1032    | 36.4 | 1360    | 48.0 | 2200    | 77.7  |
| Compartments                         | #      |          | 1     |      | 1     |      | 3       |      | 3       |      | 3       |      | 3+3     |       |
| <b>Door Open</b>                     |        |          |       |      |       |      |         |      |         |      |         |      |         |       |
| Door Open Size Width                 | mm     | Inch     | 300   | 11.8 | 300   | 11.8 | 400     | 15.7 | 400     | 15.7 | 450     | 17.7 | 450     | 17.7  |
| Door Open Size Length                | mm     | Inch     | 425   | 16.7 | 515   | 20.3 | 600     | 23.6 | 705     | 27.8 | 760     | 29.9 | 1160    | 45.7  |
| <b>Motor</b>                         |        |          |       |      |       |      |         |      |         |      |         |      |         |       |
| Size                                 | kW     | HP       | 3.7   | 5    | 5.6   | 7.5  | 11.25   | 15   | 15      | 20   | 22      | 30   | 37.5    | 50    |
| <b>Cylinder Speed (Programmable)</b> |        |          |       |      |       |      |         |      |         |      |         |      |         |       |
| Washer Speed                         | rpm    | G        | 42.5  | 0.8  | 42.5  | 0.8  | 36      | 0.8  | 36      | 0.8  | 34.5    | 0.8  | 32      | 0.8   |
| Balance Speed                        | rpm    | G        | 62    | 1.7  | 62    | 1.7  | 53      | 1.7  | 53      | 1.7  | 50      | 1.7  | 46.5    | 1.7   |
| Medium extract Speed                 | rpm    | G        | 825   | 300  | 825   | 300  | 700     | 300  | 700     | 300  | 669     | 300  | 620     | 300   |
| High extract Speed                   | rpm    | G        | 890   | 350  | 890   | 350  | 765     | 350  | 765     | 350  | 720     | 350  | 650     | 330   |
| <b>Drain System</b>                  |        |          |       |      |       |      |         |      |         |      |         |      |         |       |
| Overflow Size                        | mm     | Inch     | 38.1  | 1.5  | 38.1  | 1.5  | 38.1    | 1.5  | 38.1    | 1.5  | 38.1    | 1.5  | 38.1    | 1.5   |
| Drain Outlet Size                    | mm     | Inch     | 76.2  | 3    | 76.2  | 3    | 102     | 4    | 102     | 4    | 102     | 4    | 102     | 4     |
| Number of drain outlet               | Std    | Option   | 1     | 2    | 1     | 2    | 1       | 2    | 1       | 2    | 1       | 2    | 2       | 2     |
| <b>Water Inlet</b>                   |        |          |       |      |       |      |         |      |         |      |         |      |         |       |
| Connection size                      |        | NPT      | 3/4"  |      | 1"    |      | 1"      |      | 1-1/4"  |      | 1-1/4"  |      | 1-1/4"  |       |
| Number Of inlets                     | Std    | Option   | 2     | 3    | 2     | 3    | 2       | 3    | 2       | 3    | 2       | 3    | 2       | 3     |
| <b>Steam Inlet</b>                   |        |          |       |      |       |      |         |      |         |      |         |      |         |       |
| Connection size                      |        | NPT      | 1/2"  |      | 1/2"  |      | 3/4"    |      | 1"      |      | 1"      |      | 1"      |       |
| <b>Chemical Supply System</b>        |        |          |       |      |       |      |         |      |         |      |         |      |         |       |
| Number of chemical comp.             |        | Standard | 5     |      | 5     |      | 5       |      | 5       |      | 5       |      | 5       |       |
| Liquid supply connection size        |        | NPT      | 1/2"  |      | 1/2"  |      | 1/2"    |      | 1/2"    |      | 1/2"    |      | 1/2"    |       |
| <b>Electrical Specifications</b>     |        |          |       |      |       |      |         |      |         |      |         |      |         |       |
| 208-240VAC, 50/60Hz, 1PH             | Amps   | Breaker  | 14    | 15   | 31    | 40   | n/a     | n/a  | n/a     | n/a  | n/a     | n/a  | n/a     | n/a   |
| 208-240VAC, 50/60Hz, 3PH             | Amps   | Breaker  | 8     | 15   | 18    | 20   | 32      | 40   | 79      | 80   | 89      | 100  | 95      | 150   |
| 380-460VAC, 50/60Hz, 3PH             | Amps   | Breaker  | 4     | 15   | 9     | 15   | 16      | 20   | 39      | 40   | 39      | 40   | 48      | 80    |
| <b>Compressed Air</b>                |        |          |       |      |       |      |         |      |         |      |         |      |         |       |
| Connection size                      |        | NPT      | --    |      | --    |      | 1/8"    |      | 1/2"    |      | 1/2"    |      | 1/2"    |       |
| Pressure Max.                        | bar    | psi      | --    |      | --    |      | 8.6 125 |      | 8.6 125 |      | 8.6 125 |      | 8.6 125 |       |
| <b>Weights</b>                       |        |          |       |      |       |      |         |      |         |      |         |      |         |       |
| Weight                               | lbs    | kg       | 2750  | 1250 | 3432  | 1560 | 5447    | 2476 | 6147    | 2794 | 7986    | 3630 | 9988    | 4540  |
| Shipping Weight                      | lbs    | kg       | 2794  | 1270 | 3476  | 1580 | 5500    | 2500 | 6204    | 2820 | 8048    | 3658 | 10050   | 4568  |

## Standard Features:

- ◆ Heavy duty construction
- ◆ All wetted parts are 304 (18/8) stainless steel
- ◆ 5 compartment supply dispenser
- ◆ 30 cycle microprocessor
- ◆ Up to 350G extraction
- ◆ Variable speed inverter drive
- ◆ Stainless steel panels

## Optional Features:

- ◆ Water reuse inlet and drain
- ◆ Direct steam heating
- ◆ EMI filter
- ◆ PC programming kit

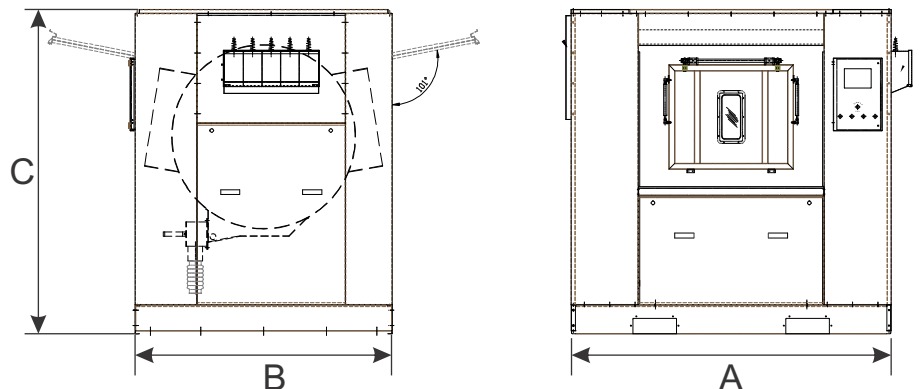

**B&C Technologies**  
 1250 West 17th Street  
 Panama City, FL 32405  
 p: 850-249-2222  
 f: 850-249-2226  
 www.bandctech.com  
 sales@bandctech.com